



Road Running Technical Council
USA Track & Field
Measurement Certificate



Name of the course _____ Distance _____

Location (state) _____ (city) _____

Type of course: road race calibration track Configuration: _____

Type of surface: paved _____ % dirt _____ % gravel _____ % grass _____ % track _____ %

Elevation above sea level) Start _____ Finish _____ Highest _____ Lowest _____

Straight line distance between start & finish _____ Drop _____ m/km Separation _____ %

Measured by (name, address, & phone) _____

Race contact (name, address, & phone) _____

Measuring Methods: bicycle steel tape electronic distance meter

Number of measurements of entire course: _____ Date(s) when course measured: _____

Race date: _____ Course paperwork submission date: _____

Replaces: _____ (if applicable) Certification code: _____

Notice to Race Director
 Use this Certification Code in **all** public
 announcements relating to your race.

Be It Officially Noted That

Based on examination of data provided by the above named measurer, the course described above and in the map attached is hereby certified as reasonably accurate in measurement according to the standards adopted by the Road Running Technical Council. If **any** changes are made to the course, this certification becomes void, and the course must then be recertified.

Validation of Course — In the event a National Open Record is set on this course, or at the discretion of USA Track & Field, a validation remeasurement may be required to be performed by a member of the Road Running Technical Council. If such a remeasurement shows the course to be short, then all pending records will be rejected and the course certification will be cancelled.

This certification expires on December 31 in the year

AS NATIONALLY CERTIFIED BY:

Date: _____

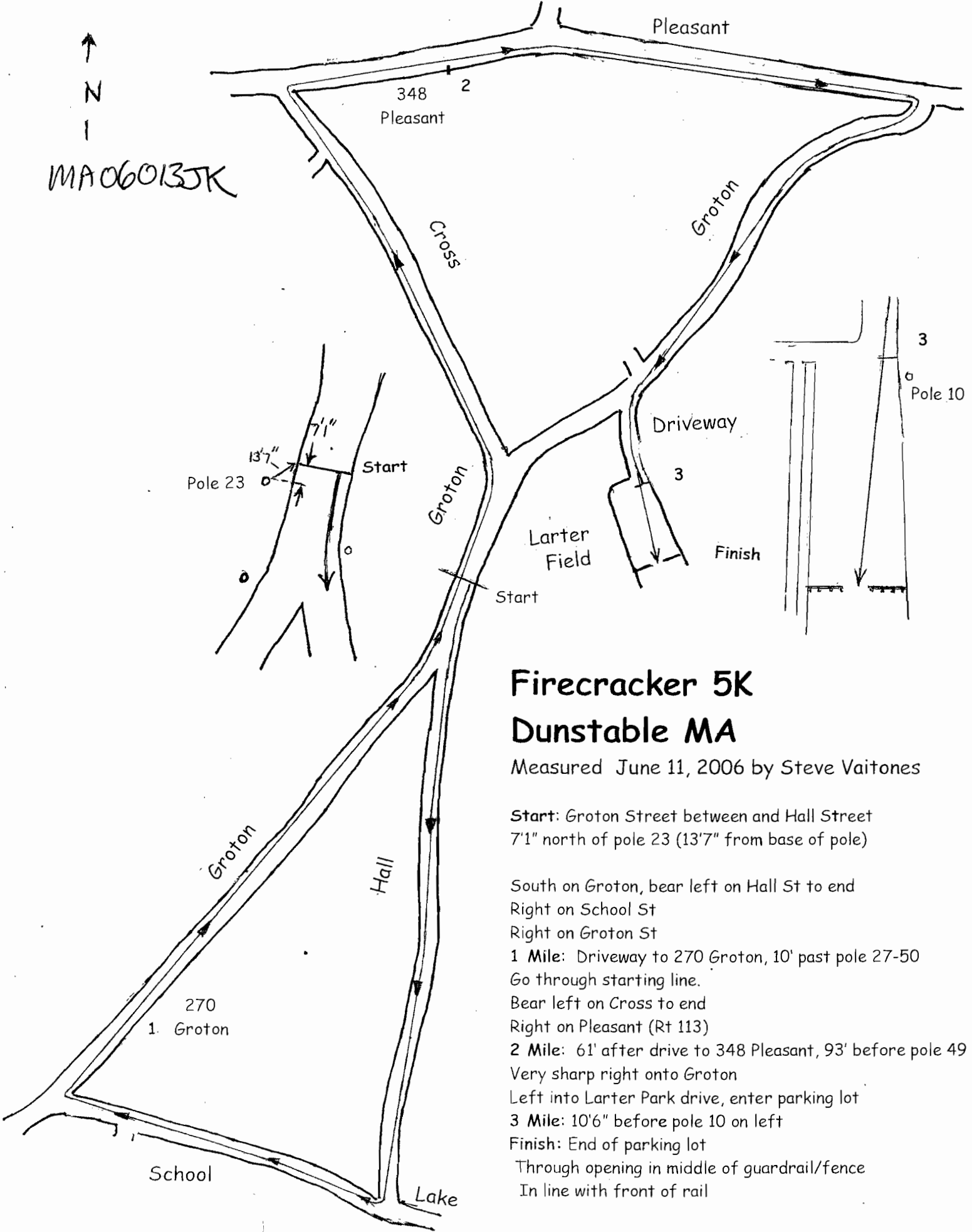

MA060135K

Firecracker 5K Dunstable MA

Measured June 11, 2006 by Steve Vaitones

Start: Groton Street between and Hall Street
7'1" north of pole 23 (13'7" from base of pole)

- South on Groton, bear left on Hall St to end
- Right on School St
- Right on Groton St
- 1 Mile:** Driveway to 270 Groton, 10' past pole 27-50
Go through starting line.
- Bear left on Cross to end
- Right on Pleasant (Rt 113)
- 2 Mile:** 61' after drive to 348 Pleasant, 93' before pole 49
Very sharp right onto Groton
- Left into Larter Park drive, enter parking lot
- 3 Mile:** 10'6" before pole 10 on left
- Finish:** End of parking lot
Through opening in middle of guardrail/fence
In line with front of rail